

## KITO L5 SERIES LEVER HOIST



Compact KITO L5 Lever Hoists allow maximum mechanical efficiency with minimum effort.

Capacity: 800kg – 9T

### Applications

- ✓ Fabrication, construction, engineering, power transmission
- ✓ Ideal for lifting, lowering, positioning, tensioning of loads

### Features

- ✓ Unique patented 'Free Wheeling Hub' mechanism.
- ✓ Smaller, lighter, high grade, alloy steel frame construction.
- ✓ Double brake pads with four braking surfaces.
- ✓ Low headroom design.
- ✓ Double Pawl & Double Spring Assemblies.
- ✓ KITO manufactured Nickel plated Grade 100 load chain.
- ✓ Needle and Ball roller bearings allow maximum mechanical efficiency with minimum effort.
- ✓ Available with load signal as overload indication.
- ✓ Also available with overload limiter which prevents hoist overload and protects the operator.
- ✓ Optional hook for special tip-loading applications.

Australian Standard: AS 1418.2

### Options



Load signal

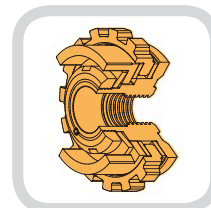

Overload limiter (OLL)



Tip load hook

# KITO L5 Series Lever Hoists

## Specifications



Capacity	Part No. (1.5m Lift)	Part No. (3m Lift)	Headroom (mm)	Lever Length (mm)	Load Chain Dia (mm) x fall	Weight (kg)	Load Chain Dia x Pitch (mm)	Load Chain Part No.
<b>L5 Lever Block</b>								
800kg	44202	45890	280	245	5.6 x 1	5.7	5.6 x 15.7	44278
1 tonne	44203	62575	300	245	5.6 x 1	5.9	5.6 x 15.7	44278
1.6 tonne	44204	45891	335	265	7.1 x 1	8.0	7.1 x 19.9	44279
2.5 tonne	44205	61917	375	265	8.8 x 1	11.2	8.8 x 24.6	44280
3.2 tonne	44206	45892	395	415	10.0 x 1	15.0	10 x 28.0	44281
6.3 tonne	44207	45893	540	415	10.0 x 2	26.0	10 x 28.0	44281
9 tonne	44208	61498	680	415	10.0 x 3	40.0	10 x 28.0	44281
<b>L5 Lever Block with overload limiter</b>								
800kg	63090	64934	280	245	5.6 x 1	6.0	5.6 x 15.7	44278
1 tonne	63091	64935	300	245	5.6 x 1	6.2	5.6 x 15.7	44278
1.6 tonne	63092	64936	335	265	7.1 x 1	8.4	7.1 x 19.9	44279
2.5 tonne	63093	64937	375	265	8.8 x 1	11.6	8.8 x 24.6	44280
3.2 tonne	63094	64938	395	415	10 x 1	15.2	10 x 28.0	44281
6.3 tonne	63095	64939	540	415	10 x 2	26.2	10 x 28.0	44281
9 tonne	63096	64940	680	415	10 x 3	40.2	10 x 28.0	44281

\*Weights shown for Lever Hoists are for standard 1.5 metre lift models. Optional lift heights available.

## KITO CLIP



### Specifications and Dimensions

Rated load (W.L.L.) (t)	Code	Applicable wire rope diameter (mm)	Mass (Net weight) (kg)	Cam dimensions (mm)			KITO PWB Part No.
				a	b	c	
0.75	KC100	8 to 10	0.9	34	16	10.5	44663
1.5	KC140	12 to 14	2.0	42	19	15.5	43332
3	KC200	16 to 20	4.8	48	20	18	43333

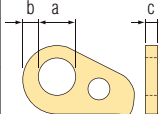

\*Kito Clip is not designed as a fixture for slinging.

#### Features

- Can be fixed easily in any location along a wire.
- Wire is firmly gripped by simply inserting the wire into the frame and pulling.
- Features a special groove that protects the wire.
- Economical and versatile.

**KITOPWB**

Premium Quality Products

For more information:

Call 1300 792 262

Visit [www.kitopwb.com.au](http://www.kitopwb.com.au)



ACUTA  
solutions